

A3500 /...

Erodierkupfer, rechteckig
EDM-copper, rectangular
Cuivre pour érosion, à section rectangulaire

Mat.: 2.0060

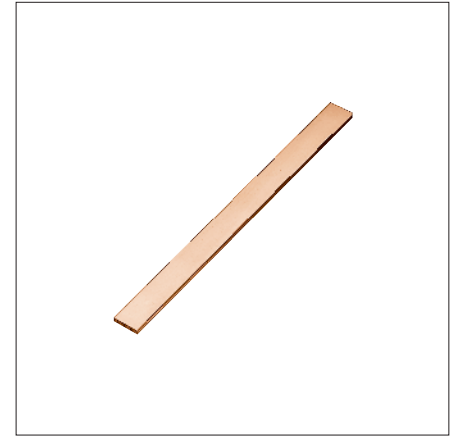
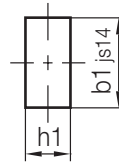
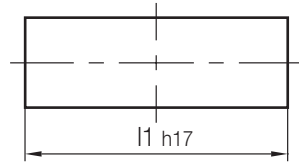

b1	h1	Tol. h1	l1	Nr./No.			
10	2	js 14	500	A3500/10x 2x500			
	3			3x500			
	4			4x500			
15	2			A3500/15x 2x500			
	3			3x500			
	4			4x500			
	5			5x500			
	6			6x500			
	8			8x500			
20	2			A3500/20x 2x500			
	3			3x500			
	4			4x500			
	5			5x500			
	6			6x500			
	8			8x500			
	10			10x500			
	15			15x500			
30	3			A3500/30x 3x500			
	4			4x500			
	5			5x500			
	6			6x500			
	8			8x500			
	10			10x500			
	15			15x500			
	20			20x500			
	40			3			A3500/40x 3x500
				4			4x500
5		5x500					
6		6x500					
8		8x500					
10		10x500					
15		15x500					
20		20x500					
50	2			A3500/50x 2x500			
	3			3x500			
	4			4x500			
	5			5x500			
	6			6x500			
	8			8x500			
	10			10x500			
	15			15x500			
	20			20x500			
	25			25x500			
60	4	js 15	500	A3500/60x 4x500			
	5			5x500			
	6			6x500			
	8			8x500			
	10			10x500			
	15			15x500			
	20			20x500			

b1	h1	Tol. h1	l1	Nr./No.	
60	30	js 15	500	A3500/60x30x500	
	40			40x500	
80	5			A3500/80x 5x500	
	6			6x500	
	8			8x500	
	10			10x500	
	15			15x500	
	20			20x500	
	25			25x500	
100	30			30x500	
	5			500	A3500/100x 5x500
	6			6x500	
	8			250	8x250
				500	8x500
	10			250	10x250
				500	10x500
	15			250	15x250
				500	15x500
	20			250	20x250
	500	20x500			
120	25			250	25x250
				500	25x500
	30			250	30x250
				500	30x500
	40			250	40x250
				500	40x500
	50			200	50x200
				400	50x400
	10			250	A3500/120x10x250
				500	10x500
160	15			250	15x250
				500	15x500
	20			250	20x250
				500	20x500
	30			250	30x250
				500	30x500
	40			250	40x250
	400	40x400			
200	10			250	A3500/160x10x250
				500	10x500
	15			250	15x250
				500	15x500
	20			250	20x250
				500	20x500
200	30			250	30x250
				500	30x500
	10			250	A3500/200x10x250
				500	10x500
	25			250	25x250
	500	25x500			

A 3501/...

Erodierkupper, quadratisch
 EDM-copper, square
 Cuivre pour érosion, à section carrée

Mat.: 2.0060

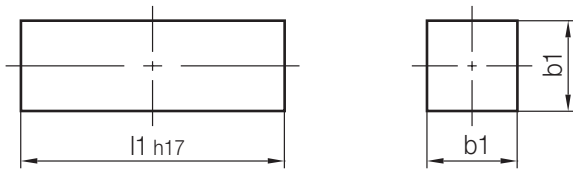
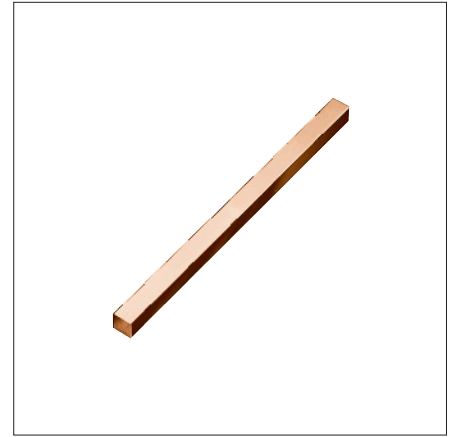

b1	Tol. b1	l1	Nr./No.
5	h 12	500	A 3501/ 5x 5x500
6		500	6x 6x500
8		500	8x 8x500
10		500	10x10x500
12		500	12x12x500
15		500	15x15x500
20		500	20x20x500
25		500	25x25x500
30		500	30x30x500
40		250	250
	500		40x500
45	250	250	A 3501/ 45x45x250
		500	45x500
50	250	250	A 3501/ 50x50x250
		500	50x500
60	250	250	A 3501/ 60x60x250
		500	60x500

b1	Tol. b1	l1	Nr./No.
80	± 2	125	A 3501/ 80x 80x125
		250	80x250
		500	80x500
		500	80x500
90	± 2	125	A 3501/ 90x 90x125
		250	90x250
		400	90x400
100	± 2	125	A 3501/ 100x100x125
		200	100x200
		315	100x315
120	± 2,5	100	A 3501/ 120x120x100
		250	120x250

A 3502 /...

Erodierkupfer, rund
EDM-copper, round
Cuivre pour érosion, à section ronde

Mat.: 2.0060

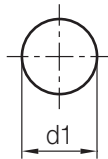
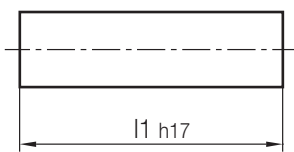
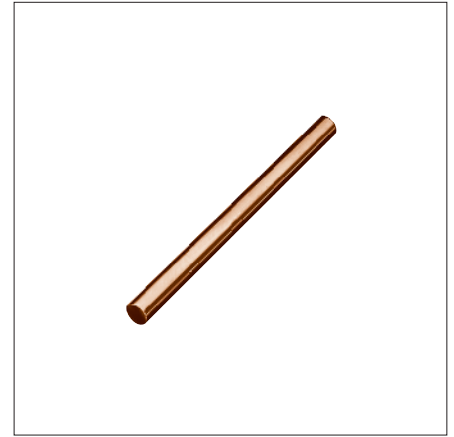

d1	Tol. d1	l1	Nr./No.
4	h 11	500	A 3502/ 4x500
5			A 3502/ 5x500
6			A 3502/ 6x500
8			A 3502/ 8x500
10			A 3502/ 10x500
12			A 3502/ 12x500
15			A 3502/ 15x500
20			A 3502/ 20x500
25			A 3502/ 25x500
30			A 3502/ 30x500
35			A 3502/ 35x500
40			A 3502/ 40x500
45			A 3502/ 45x500

d1	Tol. d1	l1	Nr./No.		
50	h 11	250	A 3502/ 50x250		
		500	500		
		55	250	A 3502/ 55x250	
			500	500	
		60	250	A 3502/ 60x250	
			500	500	
		70	± 2	250	A 3502/ 70x250
				500	500
		80	± 2	250	A 3502/ 80x250
				500	500
200	A 3502/ 90x200				
90	± 2	400	400		

d1	Tol. d1	l1	Nr./No.	
100	± 2	100	A 3502/ 100x100	
		200	200	
		315	315	
		120	32	A 3502/ 120x 32
			125	125
150	± 3	250	250	
		32	A 3502/ 150x 32	
		100	100	
		200	200	
180	± 3	25	A 3502/ 180x 25	
		32	32	
		200	32	A 3502/ 200x 32

A 3503 /...

Erodierkupfer, Rohr
EDM-copper, pipe
Cuivre pour érosion, à section creuse

Mat.: 2.0060

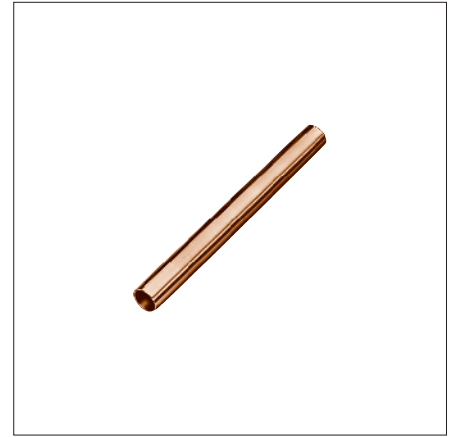
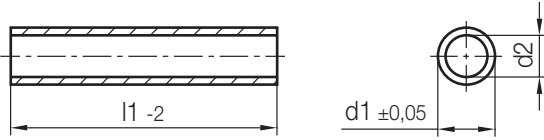

d1	d2	l1	Nr./No.
2,5	0,5	200	A3503/2,5x0,5x200
2,8	0,8		2,8x0,8x200
3	1		3 x1 x200
3,5	1,5		3,5x1,5x200
4	2		4 x2 x200
4,5	2,5		4,5x2,5x200
5	3		5 x3 x200
5,5	3,5		5,5x3,5x200
6	4		6 x4 x200
6,5	4,5		6,5x4,5x200
7	5	7 x5 x200	
7,5	5,5	7,5x5,5x200	
8	6	8 x6 x200	

d1	d2	l1	Nr./No.
8,5	6,5	200	A3503/ 8,5x 6,5x200
9	7		9 x 7 x200
9,5	7,5		9,5x 7,5x200
10	8		10 x 8 x200
10,5	8,5		10,5x 8,5x200
11	9		11 x 9 x200
11,5	9,5		11,5x 9,5x200
12	10		12 x10 x200
14	12		14 x12 x200
16	14		16 x14 x200
18	16	18 x16 x200	
20	18	20 x18 x200	

A 3504 /...

Startloch-Elektrode, Rohr
Start hole electrode, pipe
Cuivre électrolytique, à section creuse

Mat.: 2.0060

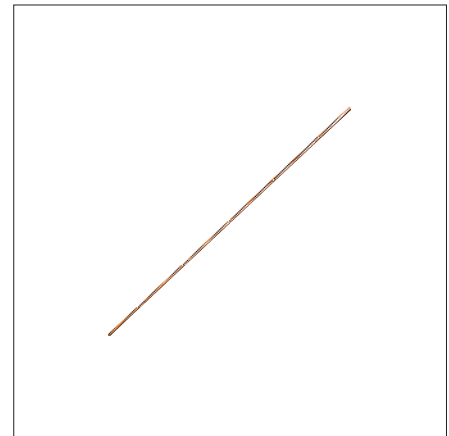
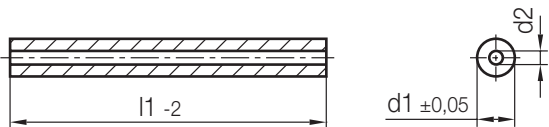

	d1	d2	l1	Nr./No.
10	0,5	0,2	315	A3504/0,5x0,2x315
	0,8	0,3		0,8x0,3x315
	1			1 x0,3x315
	1,5			1,5x0,3x315

	d1	d2	l1	Nr./No.
10	2	0,3	315	A3504/2 x0,3x315
	2,5			2,5x0,3x315
	3			3 x0,3x315