

Z14W/...

Führungsbuchse, für Auswerferpaket, selbstschmierend
 Guide bush, for ejector assembly, self-lubricating
 Bague de guidage, pour batterie d'éjection, autolubrifiante

Mat.: 2.0975
 max. °C: 200

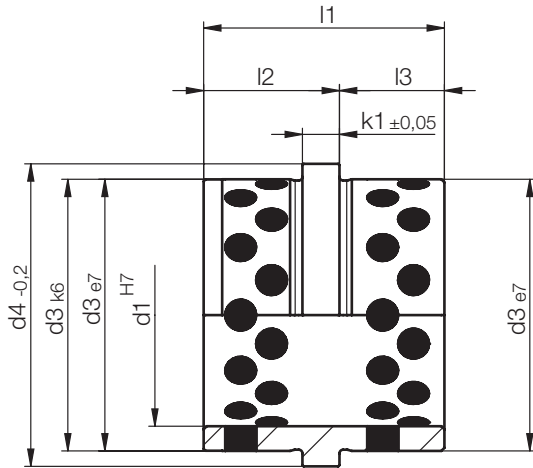

k1	l1	d4	d3	d1	l2	l3	Nr./No.
6	26	35	30	24	17	9	Z 14 W / 24 x 17 x 9
	29					12	12
	26	49	44	36	22	9	Z 14 W / 36 x 17 x 9
	39					17	22 x 17
	49	63	58	48	27	22	Z 14 W / 48 x 22 x 17
							27 x 22

Z16W/...

Flachgleitlager, selbstschmierend
 Guide rail, self-lubricating
 Rail de guidage, autolubrifiant

Mat.: 2.0492
 max. °C: 200

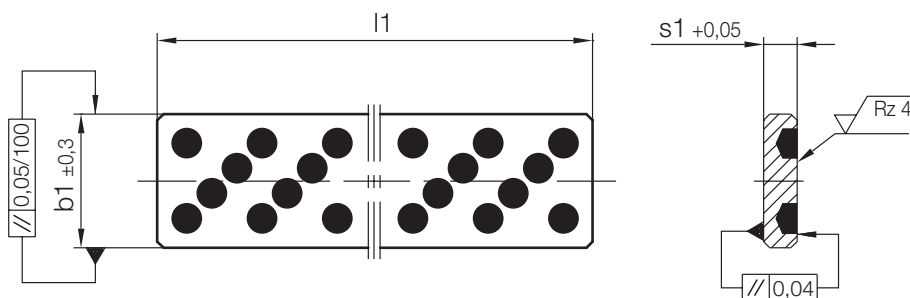
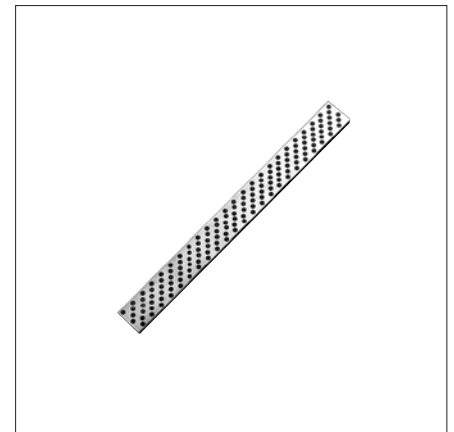

b1	s1	l1	Nr./No.
32	8	500	Z 16 W / 32 x 8 x 500
50	10		50 x 10 x 500
80	12		80 x 12 x 500