

Z 1552 /...

Leitgewindebuchse, Rohling
 Pilot thread bushing, blank
 Patron à filet, Ébauche

Mat.: 2.0550

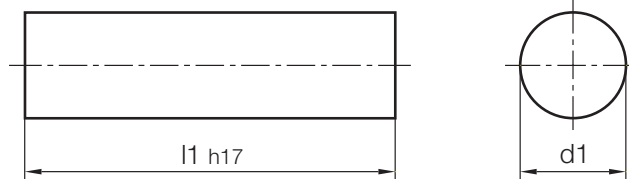
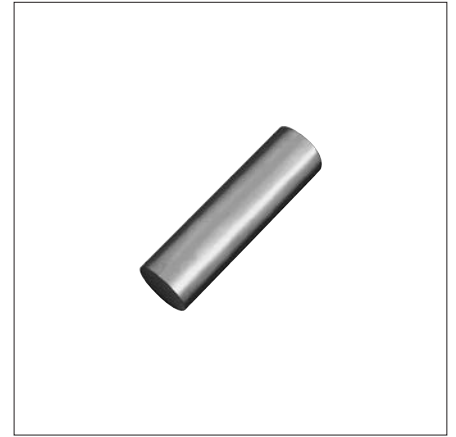

| d1 | Tol. d1 | l1 | Nr./No. |
|----|---------|-----|---------------|
| 25 | h 12 | 315 | Z 1552/25x315 |
| 32 | | | 32x315 |
| 40 | | | 40x250 |
| 50 | | | 50x250 |

| d1 | Tol. d1 | l1 | Nr./No. |
|-----|---------|-----|----------------|
| 60 | js 16 | 200 | Z 1552/ 60x200 |
| 75 | | | 75x200 |
| 90 | js 17 | 160 | 90x160 |
| 100 | | | 100x160 |

Z 15W /...

Flachgleitlager, selbstschmierend
 Slide plate, self-lubricating
 Plaque de frottement, autolubrifiant

Mat.: 2.0492
 max. °C: 200

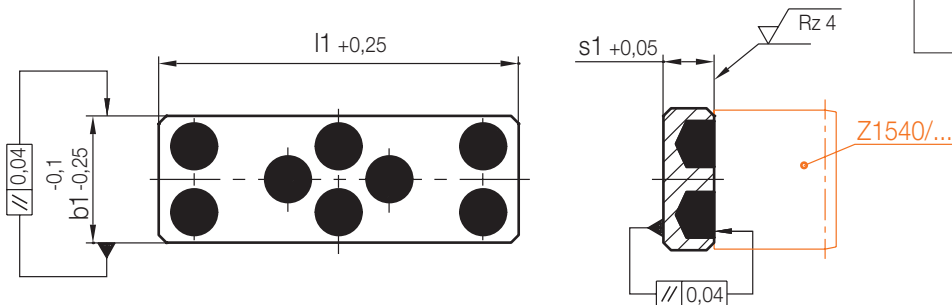

| b1 | s1 | l1 | Nr./No. |
|----|----|----|----------------|
| 16 | 8 | 40 | Z 15W/16x 8x40 |
| 18 | | 50 | 18x 8x50 |
| 20 | 10 | 63 | 20x10x63 |
| 25 | | 71 | 25x10x71 |
| 28 | | 80 | 28x10x80 |