

Z20/...

Zentrierhülse
Centring sleeve
Douille de centrage

Mat.: ≈ 1.0401/690 + 70 HV 30
≈ DIN 16759

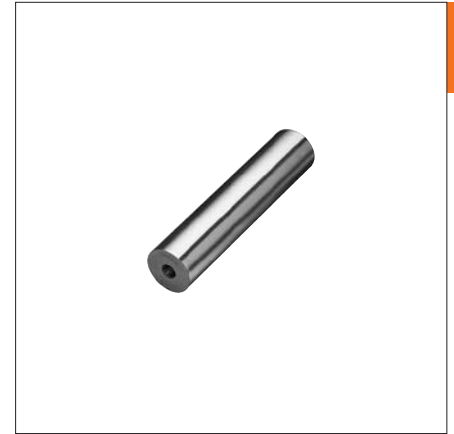
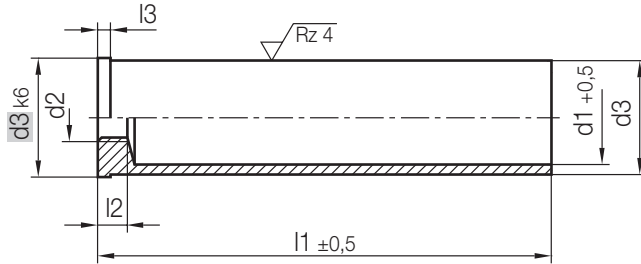

1

l3	l2	d2	d1	d3	Tol. d3	l1	Nr./No.					
2,5	8	M8	11	14	g6	20	Z20/14x 20					
						30	30					
						40	40					
						50	50					
						60	60					
						70	70					
						80	80					
						100	100					
						10	M12	16	20	g6	30	Z20/20x 30
											40	40
											50	50
											60	60
	80	80										
	100	100										
	120	120										
	140	140										
	160	160										
	13	21	26	30	f6						30	Z20/26x 30
											40	40
											50	50
						60	60					
						80	80					
						100	100					
		120				120						
140		140										
160		160										
180		180										
25		30				30	30	f6	40	Z20/30x 40		
									50	50		
	60		60									
	80		80									
	100		100									
	120		120									
140	140											
160	160											
180	180											
200	200											
220	220											
240	240											

l3	l2	d2	d1	d3	Tol. d3	l1	Nr./No.						
4	16	M12	33	42	g6	40	Z20/42x 40						
						60	60						
						80	80						
						100	100						
						120	120						
						140	140						
						160	160						
						180	180						
						200	200						
						220	220						
						240	240						
						260	260						
						280	280						
						300	300						
						43	54	f6	60	54	f6	60	Z20/54x 60
												80	80
												120	120
												160	160
												180	180
												200	200
												220	220
												240	240
												260	260
												280	280
	300	300											
	320	320											
	54	66	80	66	66	f6	80	Z20/66x 80					
							120	120					
							160	160					
							180	180					
							200	200					
							220	220					
							240	240					
							260	260					
							280	280					
							300	300					
320							320						