

Z20/...

Zentrierhülse
Centring sleeve
Douille de centrage

Mat.: ≈ 1.0401/690 + 70 HV 30
≈ DIN 16759

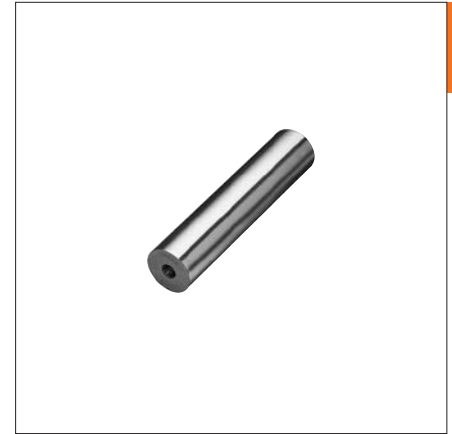
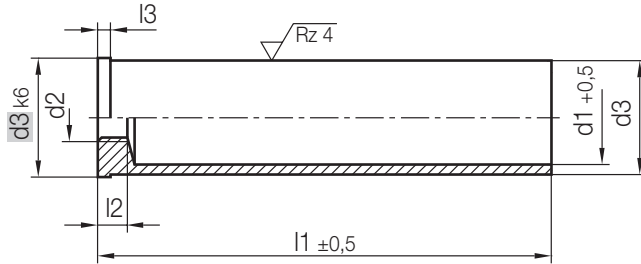

1

l3	l2	d2	d1	d3	Tol. d3	l1	Nr./No.					
2,5	8	M8	11	14	g6	20	Z20/14x 20					
						30	30					
						40	40					
						50	50					
						60	60					
						70	70					
						80	80					
						100	100					
						10	M12	16	20	g6	30	Z20/20x 30
											40	40
	50	50										
	60	60										
	80	80										
	100	100										
	120	120										
	140	140										
	160	160										
	13			21	26						f6	30
						40	40					
						50	50					
60						60						
80						80						
100						100						
120						120						
140						140						
160						160						
180						180						
			25	30	f6	40	Z20/30x 40					
						50	50					
						60	60					
						80	80					
						100	100					
						120	120					
						140	140					
						160	160					
						180	180					
						200	200					
220	220											
240	240											
4	16	M12	33	42	g6	40	Z20/42x 40					
						60	60					
						80	80					
						100	100					
						120	120					
						140	140					
						160	160					
						180	180					
						200	200					
						220	220					
	240	240										
	260	260										
	280	280										
	300	300										
	43			43	54	f6	60	Z20/54x 60				
							80	80				
							120	120				
							160	160				
							180	180				
							200	200				
220							220					
240							240					
260							260					
280							280					
300	300											
320	320											
54			54	66	f6	80	Z20/66x 80					
						120	120					
						160	160					
						180	180					
						200	200					
						220	220					
						240	240					
						260	260					
						280	280					
						300	300					
320	320											