

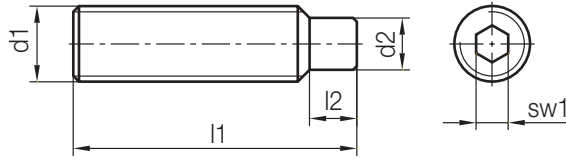

Z34/...

Gewindestift, mit Innensechskant und Zapfen
Set screw, with Hexagon socket, with dog point
Tige filetée à six pans creux, à ergott

Mat.: min. 1455 N/mm²
DIN EN ISO 4028 (DIN 915 - 45H)



2

	sw1	l2	d2	d1	l1	Nr./No.	
20	2	2	2,5	M 4	10	Z34/ 4x10	
						6	18
	4	4	5,5	M 8	20	8x20	
						30	8x30
						10	10x30
10	5	5	7	M 10			

	sw1	l2	d2	d1	l1	Nr./No.
10	5	5	7	M 10	40	Z34/10x40
						50
	6	7	8,5	M 12	30	12x30
						40
	8	8	12	M 16	45	16x45
						55

Z35/...

Gewindestift, mit Innensechskant
Set screw, with Hexagon socket
Tige filetée à six pans creux, à six pans creux

Mat.: min. 1455 N/mm²
DIN EN ISO 4026 (DIN 913 - 45H)

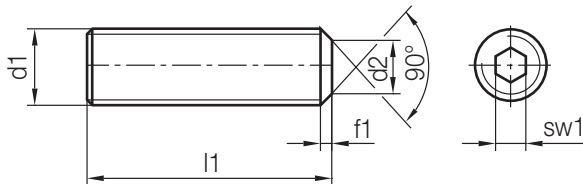

	sw1	f1	d2	d1	l1	Nr./No.				
20	1,5	0,5	2	M 3	6	Z35/3x 6				
					8	8				
					2	0,75	2,5	M 4	6	Z35/4x 6
									8	8
	10	10								
	12	12								
	2,5	0,75	3,5	M 5	6	Z35/5x 6				
					8	8				
					10	10				
					12	12				
					16	16				
					20	20				
	3	1	4	M 6	6	Z35/6x 6				
					8	8				
					10	10				
					12	12				
16					16					
20					20					
25					25					
10					10					
4	1,25	5,5	M 8	8	Z35/ 8x 8					
				10	10					

	sw1	f1	d2	d1	l1	Nr./No.				
20	4	1,25	5,5	M 8	12	Z35/ 8x12				
					16	16				
					20	20				
					25	25				
					30	30				
					40	40				
					5	1,5	7	M 10	10	Z35/10x10
									12	12
	16	16								
	20	20								
	10	6	1,75	8,5	M 12	12	Z35/12x12			
						16	16			
20						20				
30						30				
8		2	12	M 16	20	Z35/16x20				
					30	30				
					40	40				