

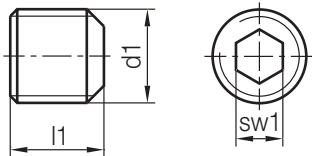

# Z351/...

Gewindestift, mit Innensechskant  
Set screw, with Hexagon socket  
Tige filetée à six pans creux, à six pans creux

Mat.: min. 1455 N/mm<sup>2</sup>  
DIN EN ISO 4026 (DIN 913-45 H)



	sw1	d1	l1	Nr./No.
10	5	<b>M10x1</b>	<b>12</b>	Z351/10x1 x12
	6	<b>M12x1,5</b>		12x1,5x12
	8	<b>M16x1,5</b>	<b>25</b>	16x1,5x25