

Z83/...

Stecktülle
Plug-in connector
Raccord cannelé

Mat.: 2.0401

Z80/... Z80PL /...
Z801/... Z801PL /...
Z807/...
Z82/...

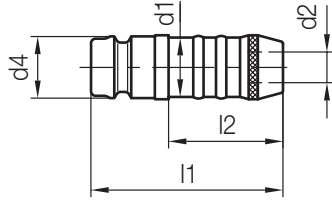

Z85/...
Z851/...
Z852/...
Z853/...
Z854/...



Typ 1

Typ 2

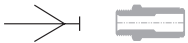
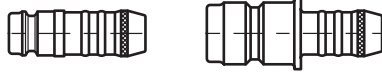

	Typ	l2	l1	d2	d4	d1	Nr./No.
10	1	13,5	25	3,5	5	5	Z83/ 5x 5
		22,5	43,5	6	9	9	9x 9
		25	42	9	13	13	13x13
1	2	32	61	13	19	19	19x19
10		13,5	29,5	3,5	9	5	9x 5
1		22,5	39,5	6	13	9	13x 9
		25	54	9	19	13	19x13

Z830/...

Übergangsnippel, mit freiem Durchgang
Adapter, open flow
Raccord de transition, à passage ouvert

Mat.: 2.0401

Z80/... Z80PL /...
Z801/... Z801PL /...
Z807/...
Z80700/...
Z808/...
Z82/...

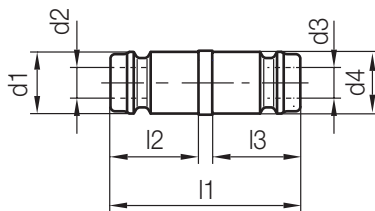

Z80/... Z80PL /...
Z801/... Z801PL /...
Z807/...
Z80700/...
Z808/...
Z82/...



Typ 1

Typ 2



Typ	p [bar]	l3	l2	l1	d2	d3	d1	d4	Nr./No.	
1	25	10	10	22	2,7	2,7	5	5	Z830/ 5x 5	
2				26,5		6		9	5x 9	
1				30,5		6		9	9x 9	
2		27	14	14	31	9	9	13	9x13	
1					46		13		13	13x13
2					59		13		19	13x19
1		27	27	59			19	19x19		