

Z900 /...

Verlängerungsrippel, mit freiem Durchgang, ablängbares Gewinde
 Extension nipple, open flow, thread can be cut as required
 Raccord d'extension, à passage ouvert, filet pour mise à longueur

Mat.: 2.0401

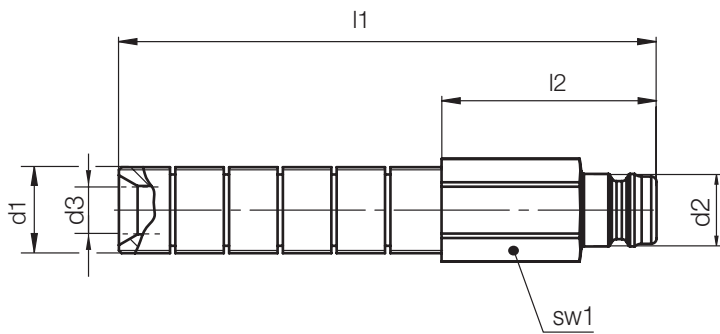

Z80/... Z805/...
 Z801/... Z8051/...
 Z802/... Z807/...
 Z803/... Z808/...
 Z804/... Z82/...
 Z825/...

Z80HT/... Z80PL /...
 Z801HT/... Z801PL /...
 Z807HT/...
 Z808HT/...

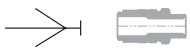

sw1	l2	d3	d2	d1	l1	Nr./No.
11	40	4,4	9	M 7x1	100	Z900/ 9x 7x1 x100
				M 8x0,75		8x0,75
		5,9		M 9x1		9x1
				M10x1		10x1
				G1/8A		G1/8
15	40	8,5	13	M14x1,5	100	Z900/13x 11x1 x100
				G1/4A		14x1,5
		9		M11x1		11x1
				M14x1,5		14x1,5
				G1/4A		G1/4
17	40	9	13	M16x1,5	100	16x1,5
				G3/8A		G3/8